

Export / Import

With the update **4.14.6** we are releasing a beta version of the **Export / Import** feature

Note: as the feature is released in beta, we will only acknowledge ideas & issues for future improvements

Only some features can be exported for now, new exporters will be released in the future to match all AMB core features

Here is an example with the radio feature:

Now you'll get an **“yml”** file named **“radio-`{date}`.yml”**.

yml* stands for **YAML** it' the export format we use for large payloads.

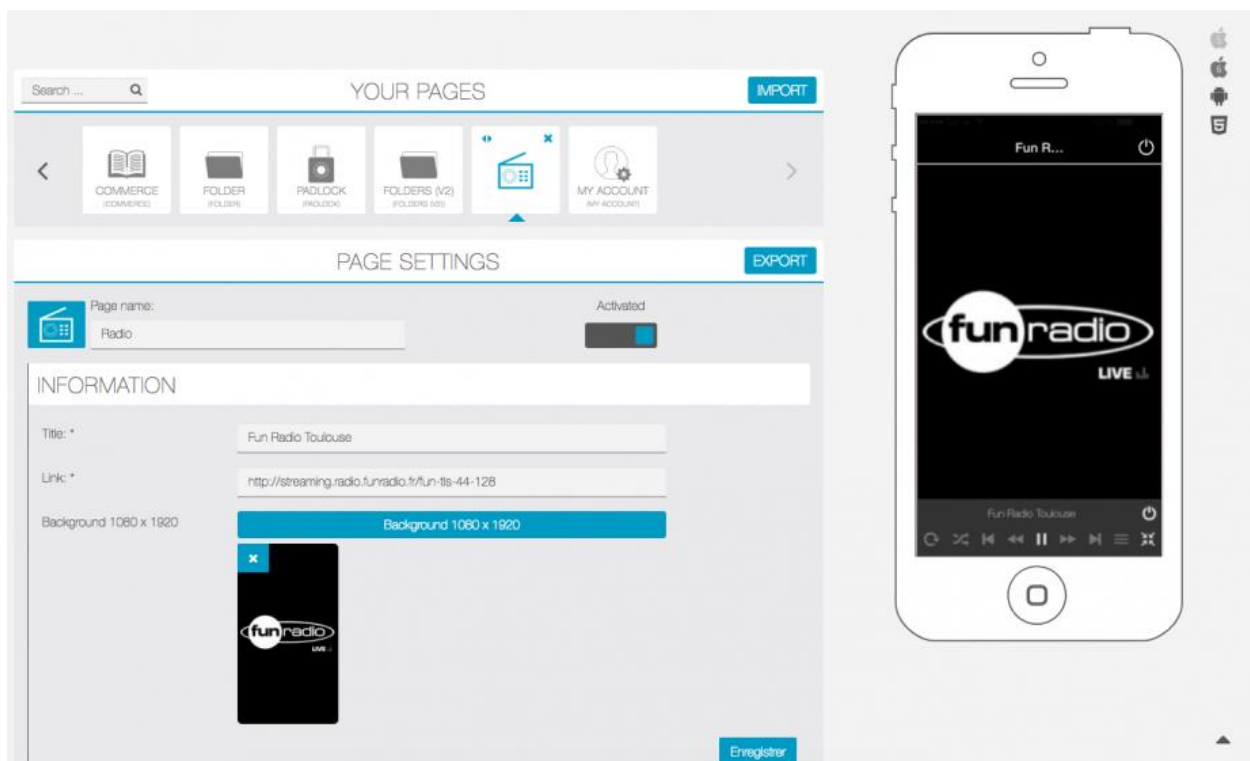

How to import a previously exported feature?

Get your **“yml”** file, and now click on the **“Import”** button on the top-right corner of the Features carousel

You'll see the modal like below, click on **“Import yml”** and select you file.

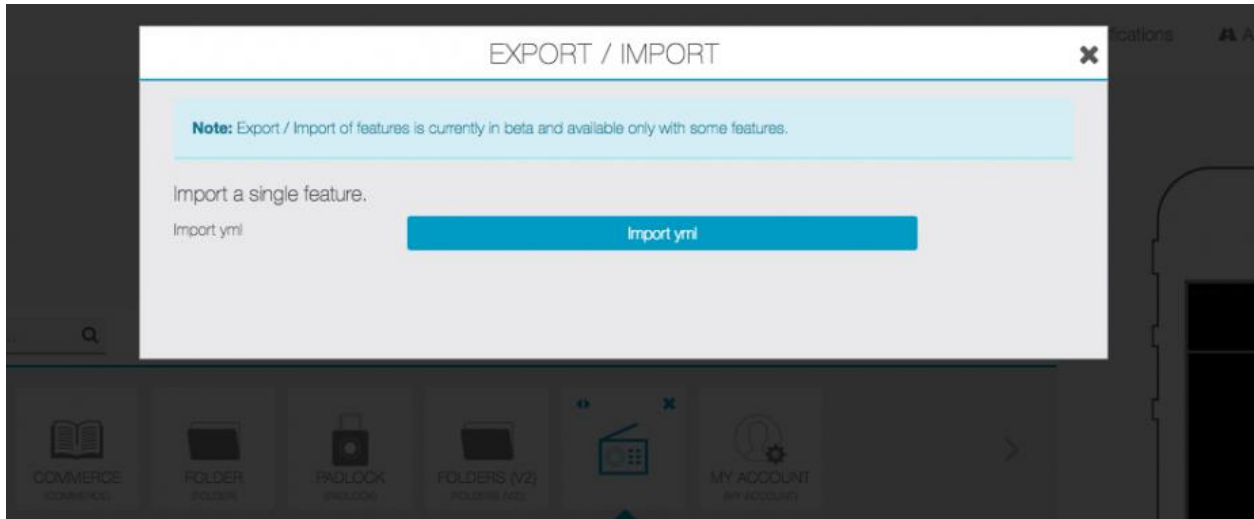

When the upload is done, reload the features page. Now at the end of the feature's carousel, you'll see the imported feature with exactly the same content as the exported one!

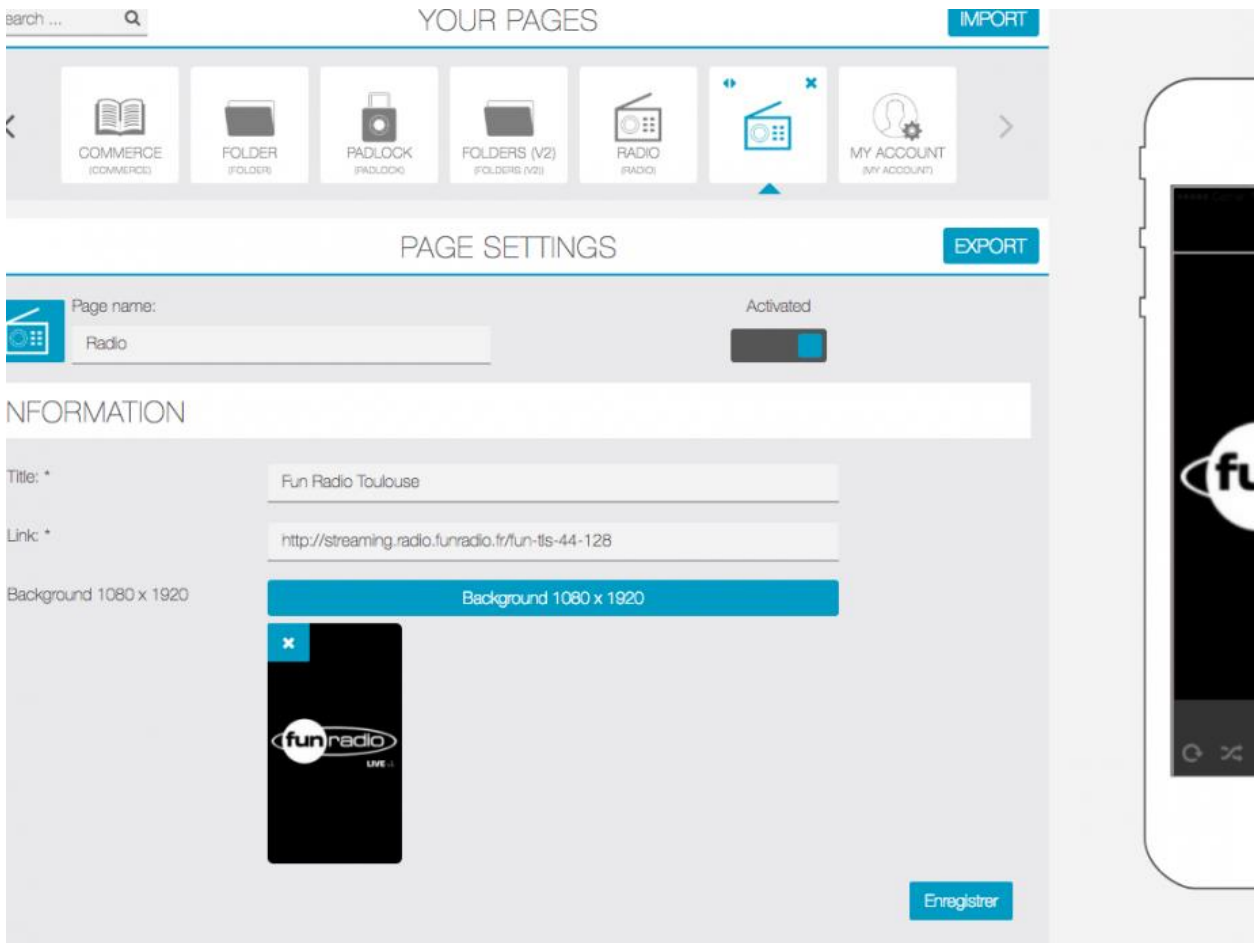

Can I export a complete application?

As this is a beta feature, we only allow single features to be exported. In a near future, with all the exporters ready, you will be able to export complete Applications.

Available features!

From 4.14.6:

- Booking
- Job
- Loyalty Card
- Discount
- QR Discount
- Push
- Radio
- RSS
- Social Gaming
- Source Code
- Tip
- Topic
- Twitter
- Weather
- Link
- Links
- WordPress v2